



# 7/8" BORE BRASS HEAVY DUTY CYLINDER

Consult factory for hydraulic applications

## 7SS-AR-1

**Mount:** Stud

**Available Stroke Lengths:** 1"

**Type:** Single Acting  
Spring Extended

Add **-N** to the end of the part number for a non-threaded rod

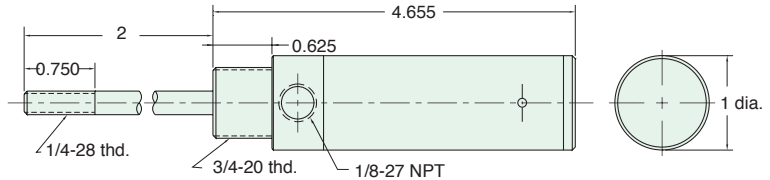

Nut included, but not shown on drawing

## 7SS-1

**Mount:** Stud

**Available Stroke Lengths:** 1"

**Type:** Single Acting  
Spring Return

Add **-N** to the end of the part number for a non-threaded rod

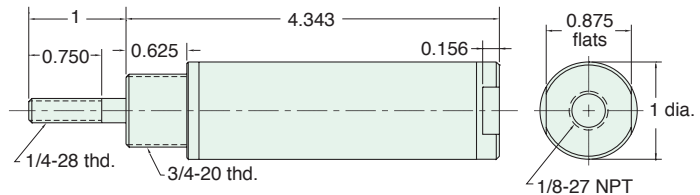

Nut included, but not shown on drawing

## 7SD-□

**Mount:** Stud

**Available Stroke Lengths:** 1", 2", 3", 5", 7", 9"

**Type:** Double Acting

**To order:** Add stroke length to the end of the part number

Add **-N** to the end of the part number for a non-threaded rod

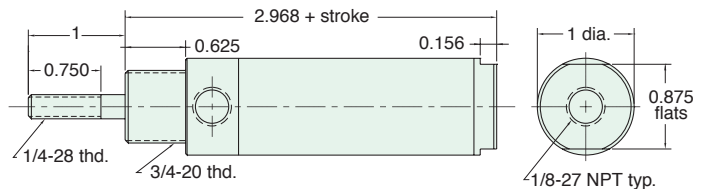

Nut included, but not shown on drawing

## 7S-1

**Mount:** Universal

**Available Stroke Lengths:** 1"

**Type:** Single Acting  
Spring Return

Add **-N** to the end of the part number for a non-threaded rod

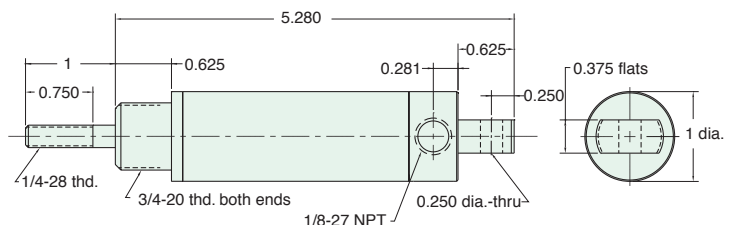

Nuts included, but not shown on drawing